

ELECTROFUSION
THREADED
SADDLES

MOLDED
FOR YOUR
INDUSTRY

IntegriFuse™



 **INTEGRITY**
Fusion Products, Inc.

TOLL FREE 1-888-770-6330

INTEGRITYFUSION.COM

The difference MOLDED Makes

Integrity Fusion continues to be the market leader in electrofusion fittings, by offering innovative solutions to all of your fusible needs. Our IntegriFuse brand EF Threaded Saddles are molded in sizes up through 48" IPS and fully pressure rated to SDR 11. Many of our EF Saddles are offered with Flexible Bases to fit several sizes of pipe mains, allowing for fewer stock items to fit a large range of projects. In addition, the flexible base allows for better fit on the pipe, helping to eliminate any gaps between the fitting and the pipe. The threaded outlet is offered in female CC or NPT No- Lead Brass or 316 Stainless Steel. Our threaded outlets are over molded, and fused onto the outlet of the saddle to ensure a permanent threaded outlet. All IntegriFuse EF Saddles come standard with the appropriate strap(s) for installation, eliminating the need for additional clamps or tooling.

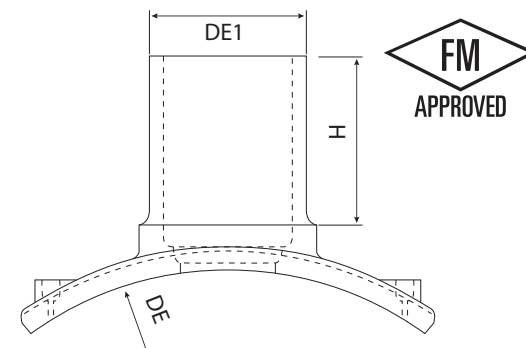

Threaded Electrofusion Branch Saddle - Water - 200 PSI (ASTM) / 232 PSI (ISO) | @ 73° F Sustainable Maximum Operating Pressure | Designed for use on IPS SDR 11 to SDR 17 HDPE Pipe

Outlet (DE1)	Base (DE)	Height (H)	Number of Straps Incl.	Item Code	Notes
2" Brass Female NPT	3" IPS	4.05"	1	200801	
2" 316SS Female NPT	3" IPS	4.05"	1	200802	
1" Brass Female NPT	3" IPS	3.55"	1	200803	
1" 316SS Female NPT	3" IPS	3.55"	1	200804	
1" Brass Female CC	3" IPS	3.55"	1	200805	
2" Brass Female NPT	4" IPS	4.05"	1	200806	
2" 316SS Female NPT	4" IPS	4.05"	1	200807	
1" Brass Female NPT	4" IPS	3.55"	1	200808	
1" 316SS Female NPT	4" IPS	3.55"	1	200809	
1" Brass Female CC	4" IPS	3.55"	1	200810	
2" Brass Female NPT	4" DIPS	4.05"	1	200811	
2" 316SS Female NPT	4" DIPS	4.05"	1	200812	
1" Brass Female NPT	4" DIPS	3.55"	1	200813	
1" 316SS Female NPT	4" DIPS	3.55"	1	200814	
1" Brass Female CC	4" DIPS	3.55"	1	200815	
2" Brass Female NPT	6" IPS - 6" DIPS	4.05"	1	200816	
2" 316SS Female NPT	6" IPS - 6" DIPS	4.05"	1	200817	
1" Brass Female NPT	6" IPS - 6" DIPS	3.55"	1	200818	
1" 316SS Female NPT	6" IPS - 6" DIPS	3.55"	1	200819	
1" Brass Female CC	6" IPS - 6" DIPS	3.55"	1	200820	
2" Brass Female NPT	8" IPS - 10" DIPS	4.05"	1	200821	FM 220
2" 316SS Female NPT	8" IPS - 10" DIPS	4.05"	1	200822	FM 220

* Flex Base Saddles cover all sizes in range listed as "BASE".

Saddles can be fused to SDR 9 pipe, but only pressure rated to SDR 11
NSF/ANSI/CAN-61 and NSF/ANSI-372(no lead brass)

Integrity Fusion Products, Inc.
270 Parkade Court
Peachtree City, GA 30269
P: 1-888-770-6330 • P: 770-632-7530
F: 770-632-7540
E: Info@IntegrityFusion.com



The difference MOLDED Makes

Integrity Fusion continues to be the market leader in electrofusion fittings, by offering innovative solutions to all of your fusible needs. Our IntegriFuse brand EF Threaded Saddles are molded in sizes up through 48" IPS and fully pressure rated to SDR 11. Many of our EF Saddles are offered with Flexible Bases to fit several sizes of pipe mains, allowing for fewer stock items to fit a large range of projects. In addition, the flexible base allows for better fit on the pipe, helping to eliminate any gaps between the fitting and the pipe. The threaded outlet is offered in female CC or NPT No- Lead Brass or 316 Stainless Steel. Our threaded outlets are over molded, and fused onto the outlet of the saddle to ensure a permanent threaded outlet. All IntegriFuse EF Saddles come standard with the appropriate strap(s) for installation, eliminating the need for additional clamps or tooling.

IntegriFuse EF Fittings are manufactured from the highest quality black high density bimodal polyethylene copolymer resin designed for use limited to, potable water, industrial, landfill, oil & gas gathering, and mining applications.

All IntegriFuse fittings meet ASTM –D2513
ASTM D3261 (where applicable)
Integrity Fusion Products, Inc.
270 Parkade Court
Peachtree City, GA 30269
P: 1-888-770-6330 • P: 770-632-7530
F: 770-632-7540
E: Info@IntegrityFusion.com

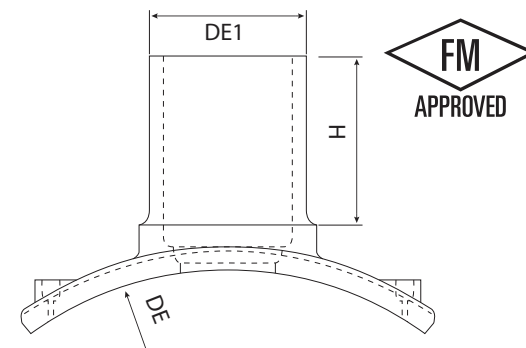

Threaded Electrofusion Branch Saddle - Water - 200 PSI (ASTM) / 232 PSI (ISO) | @ 73° F Sustainable Maximum Operating Pressure | Designed for use on IPS SDR 11 to SDR 17 HDPE Pipe

Outlet (DE1)	Base (DE)	Height (H)	Number of Straps Incl.	Item Code	Notes
1" Brass Female NPT	8" IPS - 10" DIPS	3.55"	1	200823	FM 220
1" 316SS Female NPT	8" IPS - 10" DIPS	3.55"	1	200824	FM 220
1" Brass Female CC	8" IPS - 10" DIPS	3.55"	1	200825	FM 220
2" Brass Female NPT	12" IPS - 18" IPS	4.05"	1	200826	FM 220
2" 316SS Female NPT	12" IPS - 18" IPS	4.05"	1	200827	FM 220
1" Brass Female NPT	12" IPS - 18" IPS	3.55"	1	200828	FM 220
1" 316SS Female NPT	12" IPS - 18" IPS	3.55"	1	200829	FM 220
1" Brass Female CC	12" IPS - 18" IPS	3.55"	1	200830	FM 220
2" Brass Female NPT	20" IPS - 22" IPS	4.05"	2	200831	FM 220
2" 316SS Female NPT	20" IPS - 22" IPS	4.05"	2	200832	FM 220
1" Brass Female NPT	20" IPS - 22" IPS	3.55"	2	200833	FM 220
1" 316SS Female NPT	20" IPS - 22" IPS	3.55"	2	200834	FM 220
1" Brass Female CC	20" IPS - 22" IPS	3.55"	2	200835	FM 220
2" Brass Female NPT	20" IPS - 36" IPS	4.05"	2	200836	FM 220
2" 316SS Female NPT	20" IPS - 36" IPS	4.05"	2	200837	FM 220
1" Brass Female NPT	20" IPS - 36" IPS	3.55"	2	200838	FM 220
1" 316SS Female NPT	20" IPS - 36" IPS	3.55"	2	200839	FM 220
1" Brass Female CC	20" IPS - 36" IPS	3.55"	2	200840	FM 220

* Flex Base Saddles cover all sizes in range listed as "BASE".

Saddles can be fused to SDR 9 pipe, but only pressure rated to SDR 11

NSF/ANSI/CAN-61 and NSF/ANSI-372 (no lead brass)

