

Molded 45° Butt Fusion Elbow

Dimension Sheet

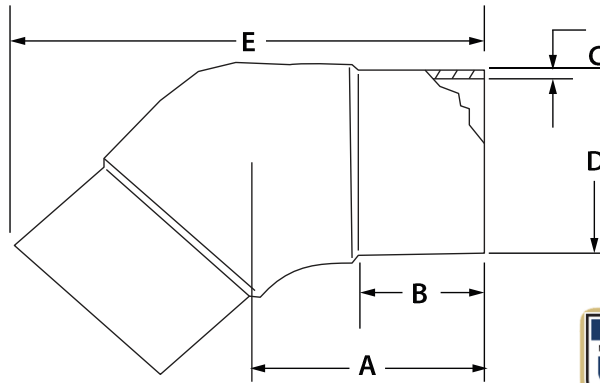

Product Family:	Injection Molded Butt Fusion Fitting	Fitting Design:	45° Elbow
Resin Status:	NSF Listed Bi-Modal Virgin Resin	Nominal Pipe Sizes:	2" – 12"
Resin Type:	ASTM D3350 designated PE3408/PE4710/PE100	Nominal Pipe Standard:	IPS and DIPS
Resin Cell Class:	4455574-CC3	Currently Available SDR's:	17, 11, 9, 7
Manufactured and tested to meet requirements of:		ASTM D2513, ASTM D3261, ANSI/AWWA C901 & C906, FM 1613, NSF 61	
For use on pipe and fittings conforming to:		ASTM D2513, ASTM D3035, ASTM F-714	

For Material and Testing information, please refer to our Molded Fitting Specification Sheet.

IPS

SDR 17 (standard dimension ratio)

125 PSI (MAOP @ 73.4° F)

Nominal Size	A [in.]	B [in.]	C [in.]	D [in.]	E [in.]	Weight [lbs.]	Item Code	FM Class
2" IPS	3.230	2.64	0.140	2.375	6.380	0.30	100002	-----
3" IPS	4.720	3.86	0.206	3.500	9.330	0.90	100006	-----
4" IPS	5.310	4.21	0.265	4.500	10.63	1.70	100010	-----
6" IPS	6.890	5.35	0.390	6.625	14.09	4.40	100014	-----
8" IPS	8.460	6.54	0.507	8.625	17.48	9.80	100018	-----
10" IPS	10.04	7.64	0.632	10.75	20.94	14.9	100022	-----
12" IPS	10.63	7.80	0.750	12.75	22.64	22.1	100024	-----

IPS

SDR 11 (standard dimension ratio)

200 PSI (MAOP @ 73.4° F)

Nominal Size	A [in.]	B [in.]	C [in.]	D [in.]	E [in.]	Weight [lbs.]	Item Code	FM Class
2" IPS	3.230	2.64	0.216	2.375	6.380	0.40	100001	FM 200
3" IPS	4.720	3.86	0.318	3.500	9.330	1.20	100005	FM 200
4" IPS	5.310	4.21	0.409	4.500	10.63	2.10	100009	FM 200
6" IPS	6.890	5.35	0.602	6.625	14.09	6.10	100013	FM 200
8" IPS	8.460	6.54	0.784	8.625	17.48	12.6	100017	FM 200
10" IPS	10.04	7.64	0.977	10.75	20.94	21.3	100021	FM 200
12" IPS	10.63	7.80	1.159	12.75	22.64	31.4	100023	FM 200

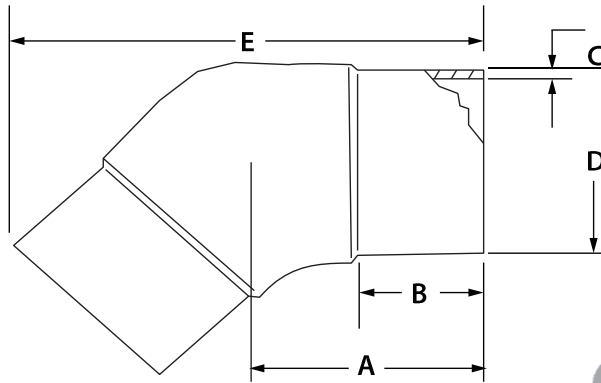

IPS

SDR 9 (standard dimension ratio)

255 PSI (MAOP @ 73.4° F)

Nominal Size	A [in.]	B [in.]	C [in.]	D [in.]	E [in.]	Weight [lbs.]	Item Code	FM Class
2" IPS	3.230	2.64	0.264	2.375	6.380	0.40	100004	FM 250
3" IPS	4.720	3.86	0.389	3.500	9.330	1.40	100008	FM 250
4" IPS	5.310	4.21	0.500	4.500	10.63	2.60	100012	FM 250
6" IPS	6.890	5.35	0.736	6.625	14.09	7.20	100016	FM 250
8" IPS	8.460	6.54	0.958	8.625	17.48	14.6	100020	FM 250
10" IPS	10.04	7.64	1.194	10.75	20.94	16.4	100043	-----
12" IPS	10.63	7.80	1.417	12.75	22.64	41.1	100030	-----

IPS

SDR 7 (standard dimension ratio)

335 PSI (MAOP @ 73.4° F)

Nominal Size	A [in.]	B [in.]	C [in.]	D [in.]	E [in.]	Weight [lbs.]	Item Code	FM Class
2" IPS	3.230	2.64	0.339	2.375	6.380	0.50	100003	FM 335
3" IPS	4.720	3.86	0.500	3.500	9.330	1.70	100007	FM 335
4" IPS	5.310	4.21	0.643	4.500	10.63	3.20	100011	FM 335
6" IPS	6.890	5.35	0.946	6.625	14.09	8.70	100015	FM 335
8" IPS	8.460	6.54	1.232	8.625	17.48	17.90	100019	FM 335
10" IPS	10.04	7.64	1.190	10.75	20.94	32.65	100044	-----
12" IPS	10.63	7.80	1.410	12.75	22.64	50.85	100031	-----

DIPS

SDR 11 (standard dimension ratio)

200 PSI (MAOP @ 73.4° F)

Nominal Size	A [in.]	B [in.]	C [in.]	D [in.]	E [in.]	Weight [lbs.]	Item Code	FM Class
4" IPS	6.050	4.10	0.436	4.800	12.00	3.20	100025	FM 200
6" IPS	7.160	5.10	0.627	6.900	14.56	7.94	100026	FM 200
8" IPS	8.320	5.20	0.823	9.050	17.56	14.65	100027	FM 200
10" IPS	9.110	6.09	1.010	11.10	16.33	23.45	100028	FM 200
12" IPS	11.11	7.56	1.200	13.18	17.56	39.50	100029	FM 200