

Product Family:	Injection Molded Butt Fusion Fitting	Fitting Design:	90° Elbow
Resin Status:	NSF Listed Bi-Modal Virgin Resin	Nominal Pipe Sizes:	2" – 12"
Resin Type:	ASTM D3350 designated PE3408/PE4710/PE100	Nominal Pipe Standard:	IPS and DIPS
Resin Cell Class:	4455574-CC3	Currently Available SDR's:	17, 11, 9, 7

Manufactured and tested to meet requirements of: ASTM D2513, ASTM D3261, ANSI/AWWA C901 & C906, FM 1613, NSF 61
 For use on pipe and fittings conforming to: ASTM D2513, ASTM D3035, ASTM F-714

For Material and Testing information, please refer to our Molded Fitting Specification Sheet.

IPS

SDR 17 (standard dimension ratio)

125 PSI (MAOP @ 73.4° F)

Nominal Size	A [in.]	B [in.]	C [in.]	D [in.]	E [in.]	Weight [lbs.]	Item Code	FM Class
2" IPS	4.36	2.64	0.140	2.375	5.63	.04	100106	-----
3" IPS	5.85	3.50	0.206	3.500	7.73	1.1	100110	-----
4" IPS	6.85	3.80	0.265	4.500	9.21	2.0	100114	-----
6" IPS	8.94	4.75	0.390	6.625	12.40	5.4	100118	-----
8" IPS	11.81	7.20	0.507	8.625	16.13	12.5	100122	-----
10" IPS	13.78	8.27	0.632	10.750	19.15	22.0	100126	-----
12" IPS	14.96	8.46	0.750	12.750	21.33	36.7	100128	-----

IPS

SDR 11 (standard dimension ratio)

200 PSI (MAOP @ 73.4° F)

Nominal Size	A [in.]	B [in.]	C [in.]	D [in.]	E [in.]	Weight [lbs.]	Item Code	FM Class
¾ IPS	3.19	2.14	0.095	1.050	3.82	0.1	100100	-----
1" IPS	3.31	2.18	0.120	1.315	4.06	0.2	100101	-----
1 ¼" IPS	3.48	2.15	1.151	1.660	4.41	0.3	100102	-----
1 ½" IPS	3.92	2.37	0.173	1.900	5.00	0.4	100103	-----
2" IPS	4.36	2.64	0.140	2.375	5.63	.05	100105	FM 200
3" IPS	5.85	3.50	0.206	3.500	7.73	1.1	100109	FM 200
4" IPS	6.85	3.80	0.265	4.500	9.21	2.0	100113	FM 200
6" IPS	8.94	4.75	0.390	6.625	12.40	5.4	100117	FM 200
8" IPS	11.81	7.20	0.507	8.625	16.13	12.5	100121	FM 200
10" IPS	13.78	8.27	0.632	10.750	19.15	22.0	100125	FM 200
12" IPS	14.96	8.46	0.750	12.750	21.33	36.7	100127	FM 200

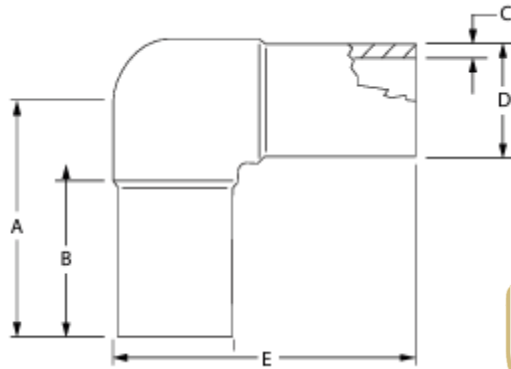

IPS

SDR 9 (standard dimension ratio)

255 PSI (MAOP @ 73.4° F)

Nominal Size	A [in.]	B [in.]	C [in.]	D [in.]	E [in.]	Weight [lbs.]	Item Code	FM Class
2" IPS	4.36	2.64	0.264	2.375	5.630	0.60	100108	FM 250
3" IPS	5.85	3.50	0.389	3.500	7.730	1.70	100112	FM 250
4" IPS	6.85	3.80	0.500	4.500	9.210	3.30	100116	FM 250
6" IPS	8.94	4.75	0.736	6.625	12.00	8.80	100120	FM 250
8" IPS	11.81	7.20	0.958	8.625	16.13	19.6	100124	FM 250
10" IPS	13.78	8.27	1.190	10.75	19.15	34.7	100136	-----
12" IPS	14.96	8.46	1.410	12.75	21.33	57.5	100134	-----

IPS

SDR 7 (standard dimension ratio)

335 PSI (MAOP @ 73.4° F)

Nominal Size	A [in.]	B [in.]	C [in.]	D [in.]	E [in.]	Weight [lbs.]	Item Code	FM Class
2" IPS	4.36	2.64	0.339	2.375	5.630	0.700	100107	FM 335
3" IPS	5.85	3.50	0.500	3.500	7.730	2.200	100111	FM 335
4" IPS	6.85	3.80	0.643	4.500	9.210	4.000	100115	FM 335
6" IPS	8.94	4.75	0.946	6.625	12.40	10.90	100119	FM 335
8" IPS	11.81	7.20	1.232	8.625	16.13	23.90	100123	FM 335
10" IPS	13.78	8.27	1.540	10.75	19.15	42.75	100137	-----
12" IPS	14.96	8.46	1.820	12.75	21.33	69.05	100135	-----

DIPS

SDR 11 (standard dimension ratio)

200 PSI (MAOP @ 73.4° F)

Nominal Size	A [in.]	B [in.]	C [in.]	D [in.]	E [in.]	Weight [lbs.]	Item Code	FM Class
4" IPS	7.550	4.10	0.436	4.800	10.04	3.20	100129	FM 200
6" IPS	9.670	5.10	0.627	6.900	13.34	8.70	100130	FM 200
8" IPS	11.58	5.20	0.823	9.050	16.33	19.5	100131	FM 200
10" IPS	13.00	5.50	1.010	11.10	18.00	28.5	100132	FM 200
12" IPS	14.00	5.87	1.200	13.20	20.00	43.8	100133	FM 200